

## Cable Reel Replacement

### Removal

1. Make sure the front wheels are aligned straight ahead.
2. Disconnect the battery negative cable, and wait at least 3 minutes.
3. Remove the driver's airbag (see page 23-128).
4. Disconnect the connector (A) from the cable reel, then remove the steering wheel bolt (B).

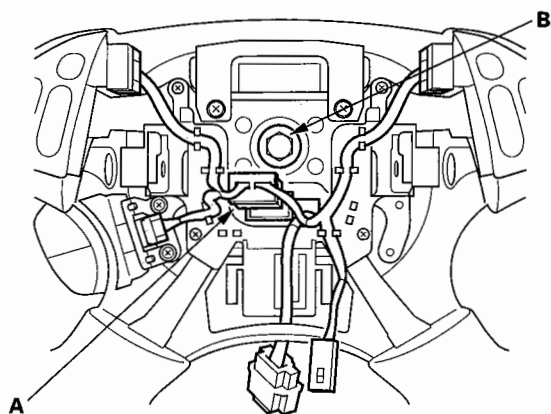

5. Confirm that the front wheels point straight ahead, then remove the steering wheel with a steering wheel puller (see step 5 on page 17-21). Do not tap on the steering wheel or steering column shaft when removing the steering wheel.
6. Carefully guide the driver's airbag connector through the opening in the steering wheel as you remove the steering wheel.

7. Remove the dashboard lower cover (A).

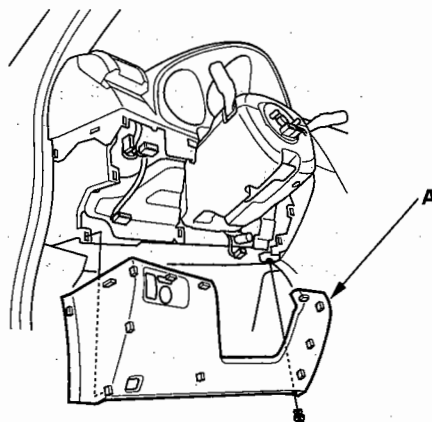

8. Remove the column cover screws (A), then remove the column covers (B, C).

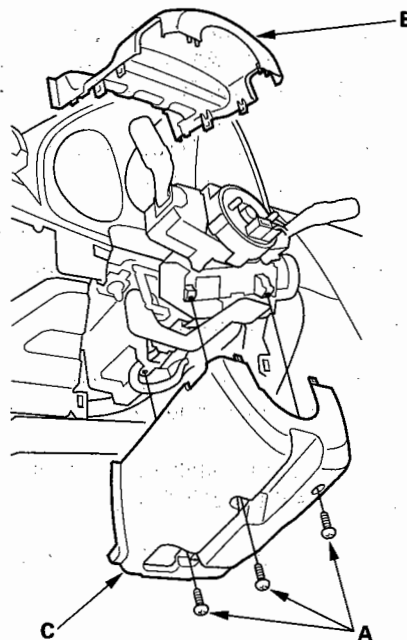



9. Disconnect the dashboard wire harness 4P connector (A) from the cable reel 4P connector (B), then disconnect the dashboard wire harness 13P connector (C) from the cable reel (D).

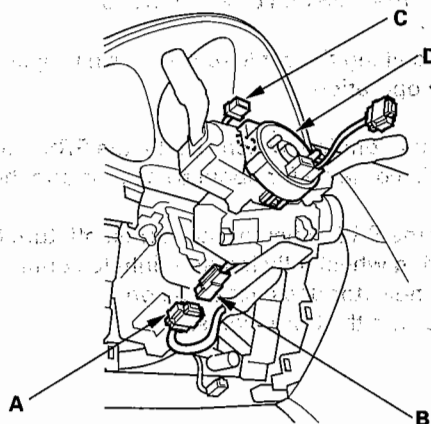

10. Release the lock tab (A) under the cable reel connector with a 90° hook shaped tool (B). Slide the tool below the cable reel connector just above the lock tab. Release the lower lock tab (C), and slide the cable reel off the column.

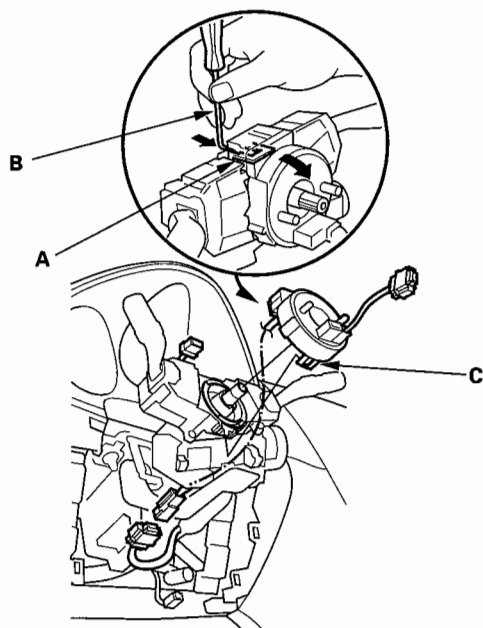

## Installation

1. Before installing the steering wheel, align the front wheels straight ahead.
2. If not already done, disconnect the battery negative cable, and wait at least 3 minutes.
3. Set the cancel sleeve (A) so that the projections (B) are aligned vertically.

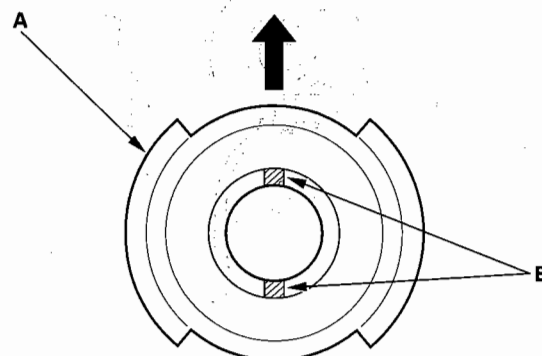

4. Carefully install the cable reel (A) on the steering column shaft. Then connect 13P connector (B) to the cable reel, and connect the 4P connector (C) to the dashboard wire harness 4P connector (D).

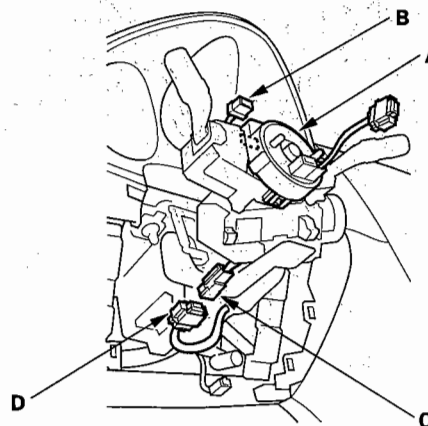

(cont'd)

## Cable Reel Replacement (cont'd)

5. Install the steering column covers.
6. If necessary, center the cable reel (New replacement cable reels come centered.). Do this by first rotating the cable reel clockwise until it stops. Then rotate it counterclockwise (about 3 turns) until the arrow mark (A) on the cable reel label points straight up.

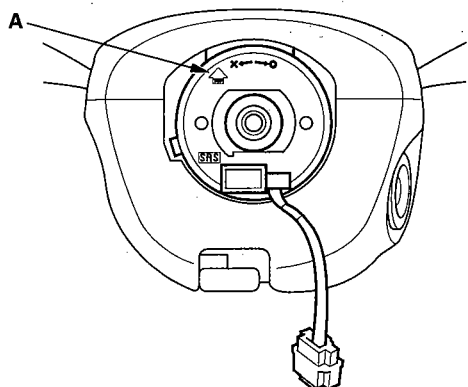

7. Align the projections on the cable reel with the holes on the steering wheel, and install the steering wheel with a new steering wheel bolt (A), then reconnect the connector.

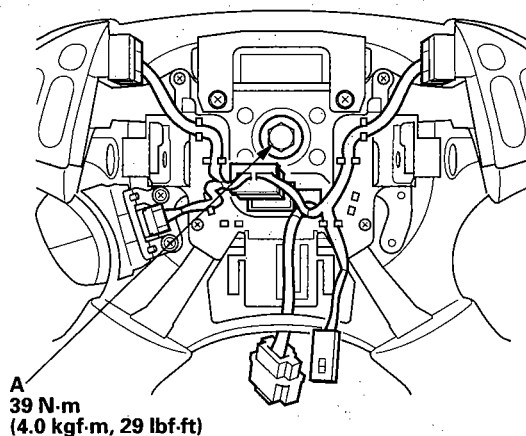

8. Install the driver's airbag (see page 23-128).

9. Reconnect the battery negative cable.

10. Connect the HDS and clear the DTCs.

11. After installing the cable reel, confirm proper system operation:

- Turn the ignition switch ON (II); the SRS indicator should come on for about 6 seconds and then go off.
- After the SRS indicator has turned off, turn the steering wheel fully left and right to confirm the SRS indicator does not come on.
- Make sure the horn works.



## SRS Unit Replacement

### Removal

1. Disconnect the battery negative cable, and wait at least 3 minutes before beginning work.
2. Disconnect both seat belt tensioner connectors (see step 6 on page 23-23).
3. Remove the center console rear section (see page 20-77).
4. Remove the center console panel (see page 20-78).
5. Remove the heater ducts.
6. Disconnect the connectors and remove the Torx bolts (A), then pull out the SRS unit.

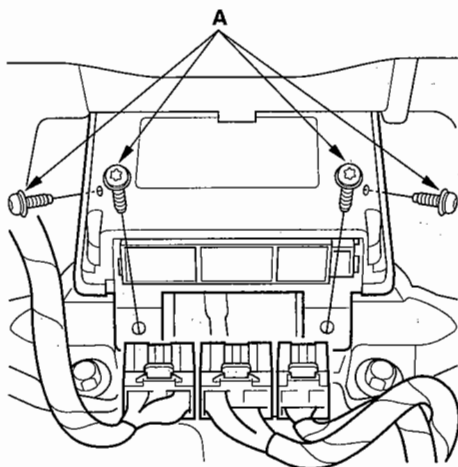

### Installation

1. Install the new SRS unit (A) with Torx bolts (B), then connect the connectors (C) to the SRS unit; push them into position until they click.

**NOTE:** Be sure the SRS unit is sitting squarely against its bracket before torquing the Torx bolts.

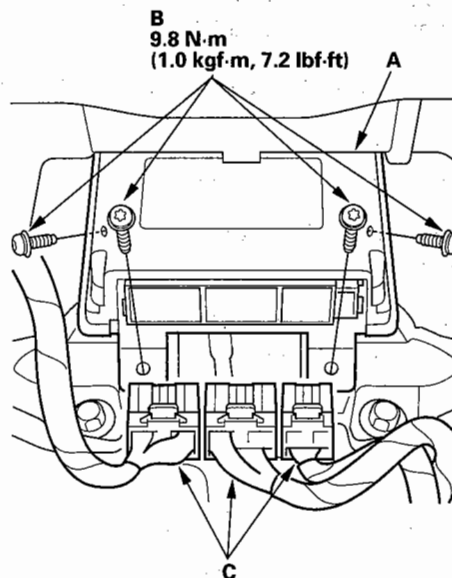

2. Reconnect both seat belt tensioner connectors (see step 6 on page 23-23).
3. Reconnect the battery negative cable.
4. Initialize the OPDS unit (see page 23-26).

**NOTE:** This is necessary for registration of serial IDs.

5. After installing the SRS unit, confirm proper system operation: Turn the ignition switch ON (II); the SRS indicator should come on for about 6 seconds and then go off.
6. Install all removed parts.

## Side Impact Sensor (First) Replacement

**NOTE:** Review the seat replacement procedure in the Body section before doing repairs or service.

### Removal

1. Disconnect the battery negative cable, and wait at least 3 minutes before beginning work.
2. Disconnect the appropriate side airbag 2P connector (see page 23-22).
3. Remove the seat assembly (see page 20-99).
4. Remove the front door sill trim and the center pillar lower trim panel (see page 20-62).
5. Disconnect the floor wire harness 2P connector from the side impact sensor (first).
6. Remove the Torx bolts (A) using a Torx T30 bit, then remove the side impact sensor (first) (B).

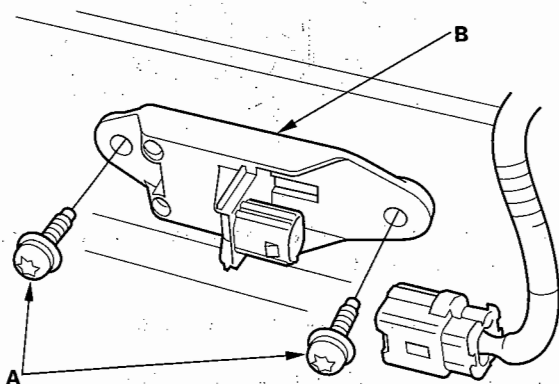

### Installation

1. Install the new side impact sensor (first) with Torx bolts (A), then connect the floor wire harness 2P connector (B) to the side impact sensor (first).

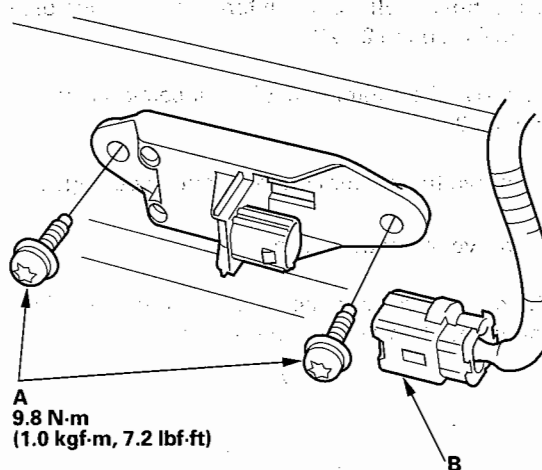

2. Reconnect the battery negative cable.
3. Install all removed parts.
4. After installing the side impact sensor (first), confirm proper system operation: Turn the ignition switch ON (II); the SRS indicator should come on for about 6 seconds and then go off.



## Side Impact Sensor (Second) Replacement

### Removal

1. Disconnect the battery negative cable, and wait at least 3 minutes before beginning work.
2. Disconnect the appropriate side curtain airbag 2P connector (see step 4 on page 23-22).
3. Disconnect the side impact sensor (second) 2P connector (A) from the side curtain airbag subharness.

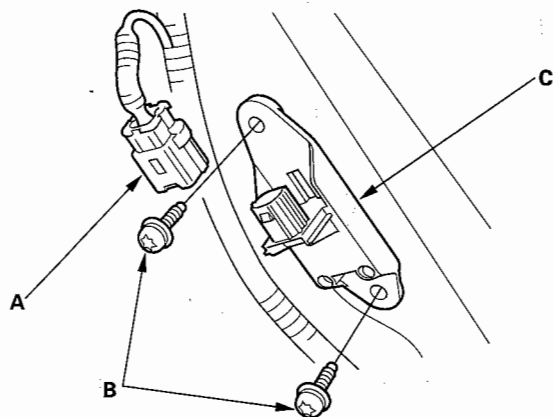

4. Remove the Torx bolts (B) using a Torx T30 bit, then remove the side impact sensor (second) (C).

### Installation

1. Install the new side impact sensor (second) (A) with Torx bolts (B) then connect the side curtain airbag subharness 2P connector (C) to the side impact sensor.

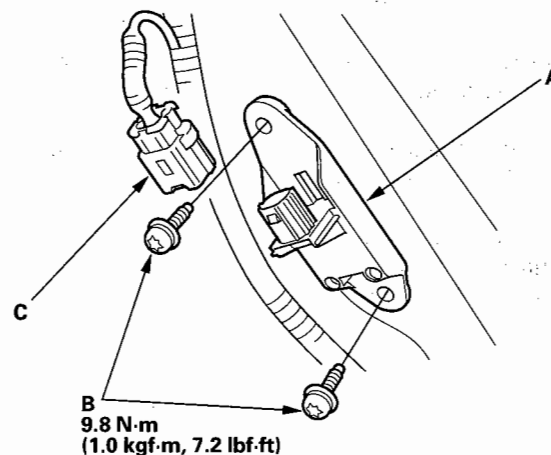

2. Reconnect the battery negative cable.
3. After installing the side impact sensor (second), confirm proper system operation: Turn the ignition switch ON (II): the SRS indicator should come on for about 6 seconds and then go off.
4. Install all removed parts.

## OPDS Unit Replacement

NOTE: Review the seat replacement procedure in the Body section before doing repairs or service.

### Removal

1. Disconnect the battery negative cable, and wait at least 3 minutes before beginning work.
2. Disconnect the passenger's side airbag harness 2P connector (see step 4 on page 23-22).
3. Remove the passenger's seat assembly (see page 20-99) and seat-back cover (see page 20-107).
4. Remove the cover (A), then disconnect the OPDS unit 8P connector D and sensor connectors (B) from the OPDS unit (C).

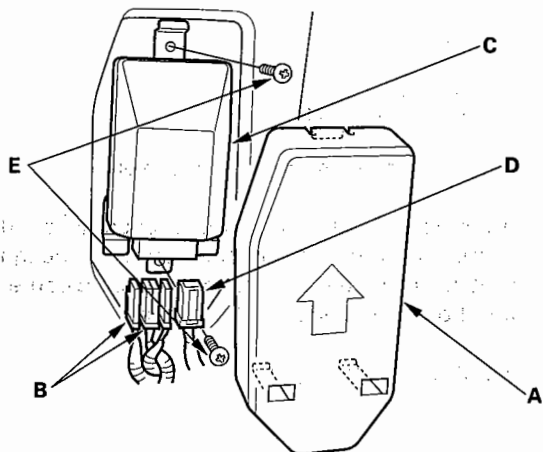

5. Remove the two screws (E) and the OPDS unit.

### Installation

1. Place the new OPDS unit (A) on the seat-back frame. Tighten the two screws (B), and connect the OPDS unit 8P connector D and sensor connectors (C) to the OPDS unit. Reinstall the cover (E).

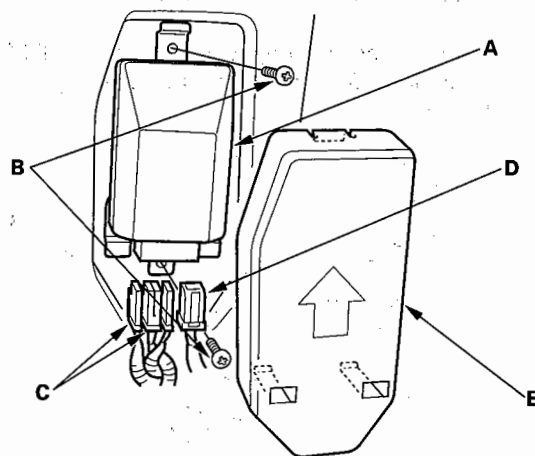

2. Install the seat-back cover in the reverse order of removal.
3. Install the seat assembly (see page 20-99), then connect the side airbag harness 2P connector.
4. Reconnect the battery negative cable.
5. Set the seat-back in a normal position, and make sure there is nothing on the front passenger's seat.
6. Initialize the OPDS unit (see page 23-26).
7. After installing the OPDS unit, confirm proper system operation: Turn the ignition switch ON (II); the SRS indicator should come on for about 6 seconds and then go off.



## Front Impact Sensor Replacement

### Removal

1. Disconnect the battery negative cable, and wait at least 3 minutes before beginning work.
2. Disconnect the driver's airbag 4P connector (see step 2 on page 23-22), the front passenger's airbag 4P connector (see step 3 on page 23-22), and both seat belt tensioner 4P connectors (see step 6 on page 23-23).
3. Remove the front inner fender (see page 20-142).
4. On driver's side, loosen the intake resonator rear mounting bolts to gain access to the impact sensor.
5. On the passenger's side, remove the windshield washer reservoir (see page 22-252) to gain access to the impact sensor.
6. Disconnect the engine compartment wire harness 2P connector (A), and remove the two Torx bolts (B) using a Torx T30 bit, then remove the front impact sensor (C).

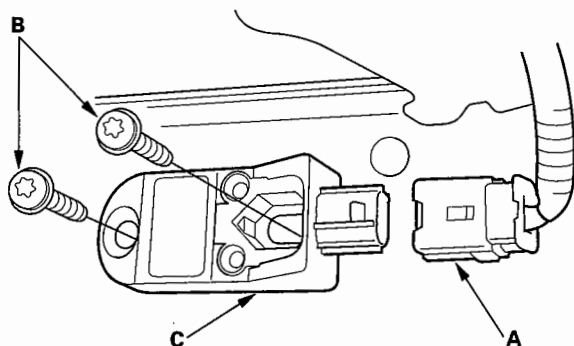

### Installation

1. Install the new front impact sensor with new Torx bolts (A), then connect the engine compartment wire harness 2P connector (B) to the front impact sensor (C).

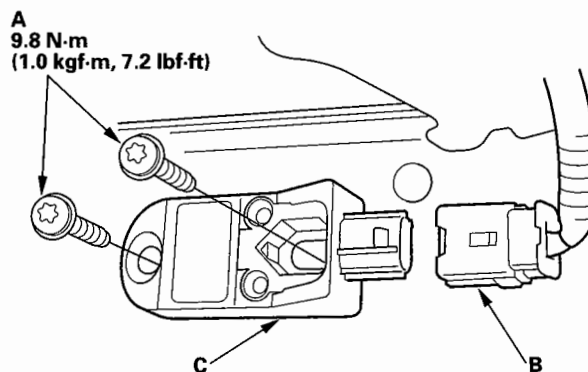

2. Reconnect the driver's airbag 4P connector (see step 2 on page 23-22), the front passenger's airbag 4P connector (see step 3 on page 23-22), and both seat belt tensioner 4P connectors (see step 6 on page 23-23).
3. Reconnect the battery negative cable.
4. After installing the front impact sensor, confirm proper system operation: Turn the ignition switch ON (II): the SRS indicator should come on for about 6 seconds and then go off.
5. Install all removed parts.



1. The first part of the report is a general introduction to the subject of the study.

2.

3.

4. The second part of the report is a detailed description of the methods used in the study.

5. The third part of the report is a discussion of the results of the study.

6. The fourth part of the report is a conclusion and a list of references.

7. The fifth part of the report is a list of appendices.

8. The sixth part of the report is a list of figures and tables.

9. The seventh part of the report is a list of footnotes.

10. The eighth part of the report is a list of references.

11. The ninth part of the report is a list of appendices.

12. The tenth part of the report is a list of figures and tables.

13. The eleventh part of the report is a list of footnotes.

14. The twelfth part of the report is a list of references.

15. The thirteenth part of the report is a list of appendices.

16. The fourteenth part of the report is a list of figures and tables.

17. The fifteenth part of the report is a list of footnotes.

18. The sixteenth part of the report is a list of references.

19. The seventeenth part of the report is a list of appendices.

20. The eighteenth part of the report is a list of figures and tables.

21. The nineteenth part of the report is a list of footnotes.

22. The twentieth part of the report is a list of references.